

DRL No.

NOTES

1. ALL DIMENSIONS IN MILLIMETRES AND ALL LEVELS IN METRES UNLESS SHOWN OTHERWISE.
2. OUTLINE DESIGN SOLUTION BASED ON THE ASSUMPTION OF A FULLY WELDED PIPELINE ALONG ITS ENTIRE ROUTE. IF THIS ASSUMPTION DOES NOT APPLY AT THE DETAILED DESIGN STAGE, THE STRUCTURAL DESIGN SOLUTION IS SUBJECT TO CHANGE.
3. APPROPRIATE STRUCTURAL DESIGN AND PIPE STRESS ANALYSIS AND SCOUR ASSESSMENT TO BE UNDERTAKEN AT THE DETAILED DESIGN STAGE.
4. ABUTMENT DESIGN TO BE DETERMINED AT THE DETAILED DESIGN STAGE, TAKING INTO ACCOUNT THE GEOTECHNICAL SURVEY RESULTS.
5. INDICATIVE PIPE BRIDGE DESIGN BASED ON THE UNDERSIDE OF THE BRIDGE BEING SET 1200 (600 FREEBOARD PLUS 600 ALLOWANCE FOR CLIMATE CHANGE) ABOVE THE 1 IN 100 YEAR FLOOD PLAIN LEVEL. CONTRACTOR TO LIAISE WITH THE ENVIRONMENT AGENCY TO CONFIRM THE TOTAL FREEBOARD AS PART OF THE DETAILED DESIGN STAGE.

REFERENCES

WN019-0205-STN-02-R1-DR-C-1301 ALWENT BECK
STRATEGIC CROSSING
PLAN

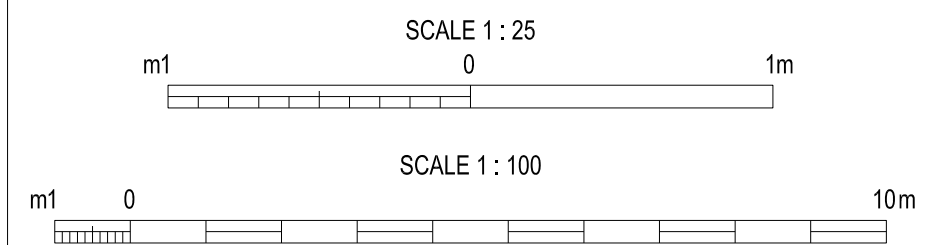

CURRENT VERSION INFORMATION

REVISION	STATUS	SUITABILITY DESCRIPTION	AUTHORED	CHECKED	REVIEWED	DATE
P01	S2	FOR INFORMATION	ARH	JDC	OC	22.10.21

NORTHUMBRIAN WATER LTD
TEES AND CENTRAL STRATEGIC TRANSFER MAINS
WHORLEY SR TO SHILDON SR
ALWENT BECK
STRATEGIC CROSSING
PIPE BRIDGE DETAILS

THIS DRAWING IS ISSUED BY STANTEC UK SUBJECT TO THE CONDITIONS THAT IT IS NOT COPIED EITHER IN WHOLE OR IN PART OR DISCLOSED TO THIRD PARTIES UNLESS PRIOR WRITTEN AUTHORISATION IS GIVEN BY STANTEC UK.
PREVIOUS VERSIONS OF THIS DRAWING SHOULD BE STAMPED SUPERSEDED OR DESTROYED
DO NOT SCALE THIS DRAWING - IF IN DOUBT ASK



CLIENT CONTRACT NO. WN019/0205	SCALE NTS	MASTER SIZE A1	STATUS S2
DRAWING NO. WN019-0205-STN-02-R1-DR-C-1302			REVISION P01

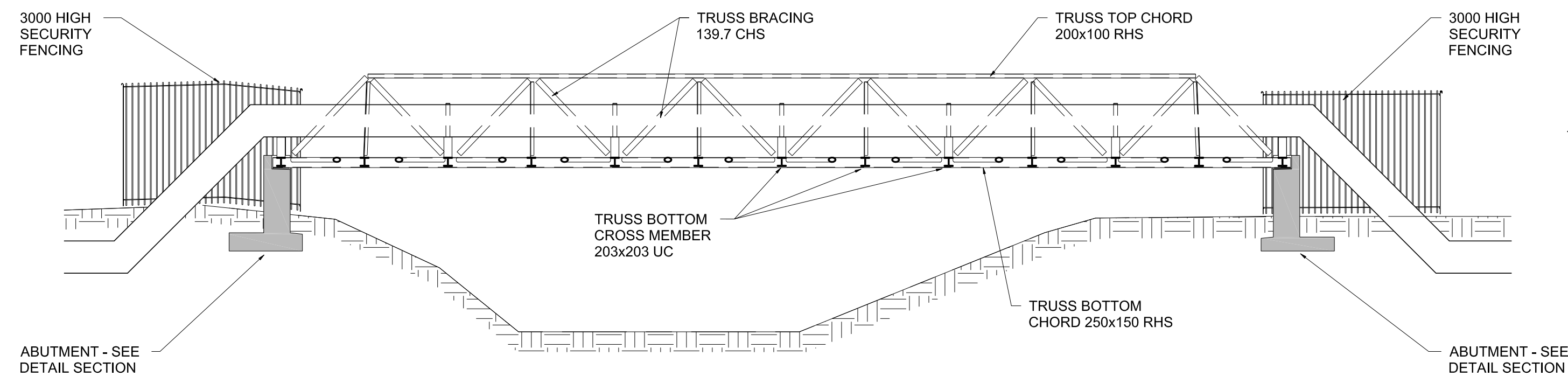

SECTION A
1 : 100

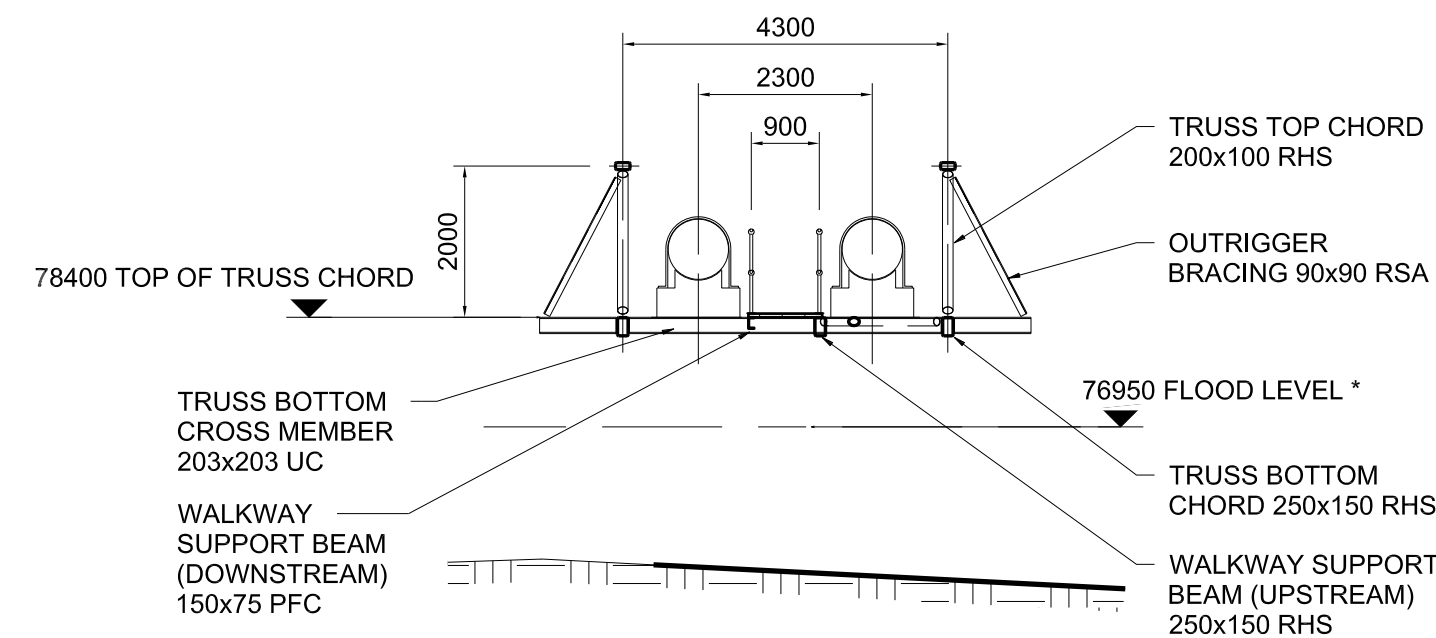

SECTION B
1 : 100

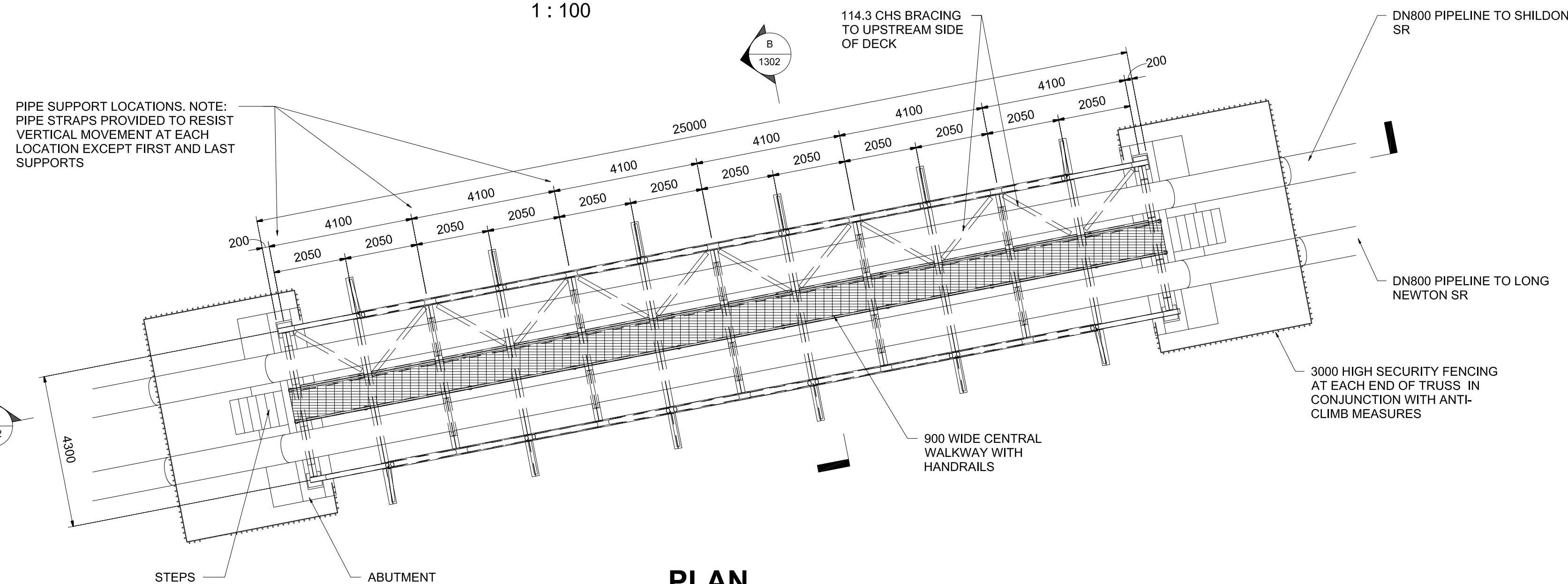

PLAN
1 : 100

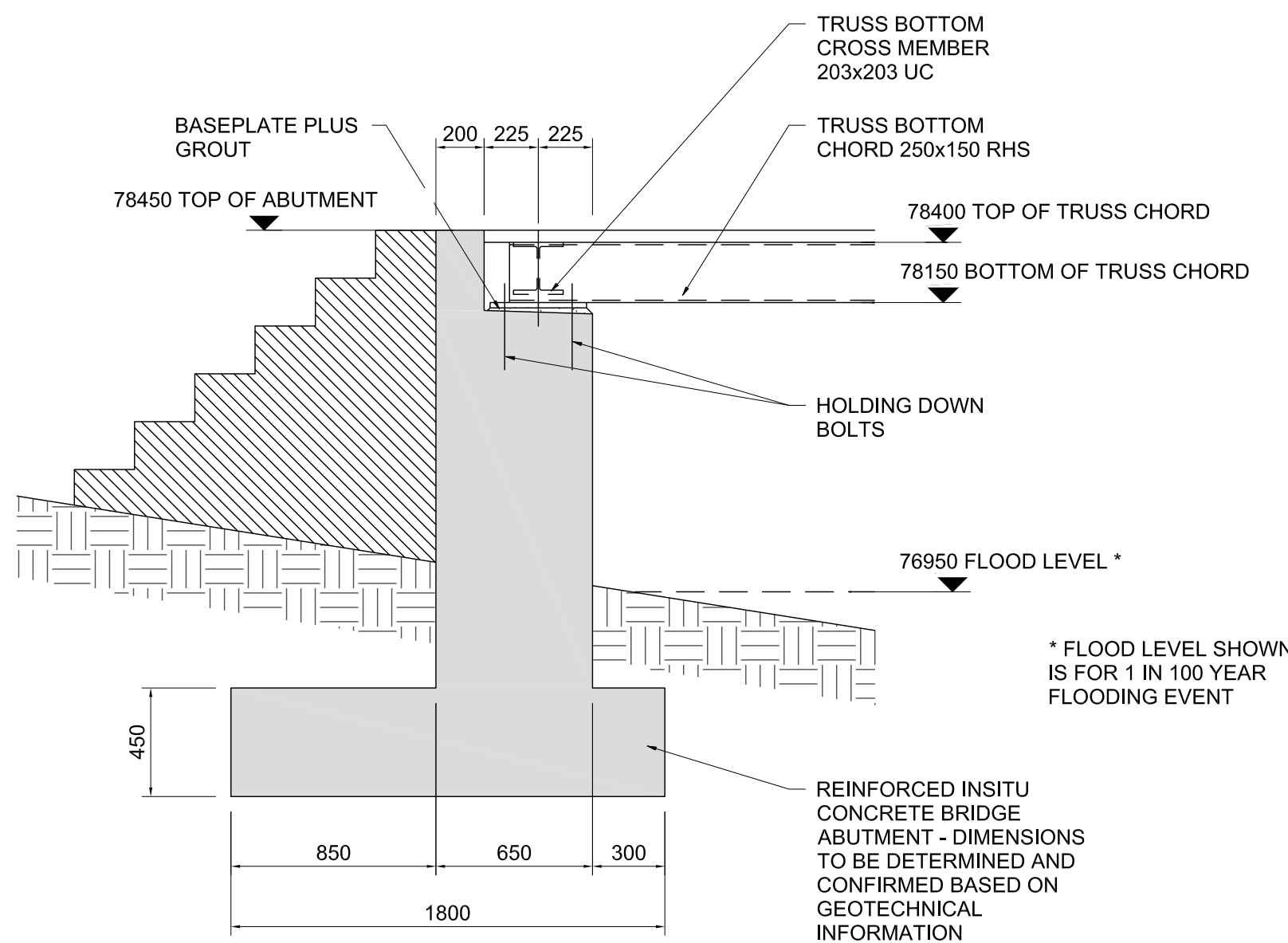

ABUTMENT DETAIL
1 : 25

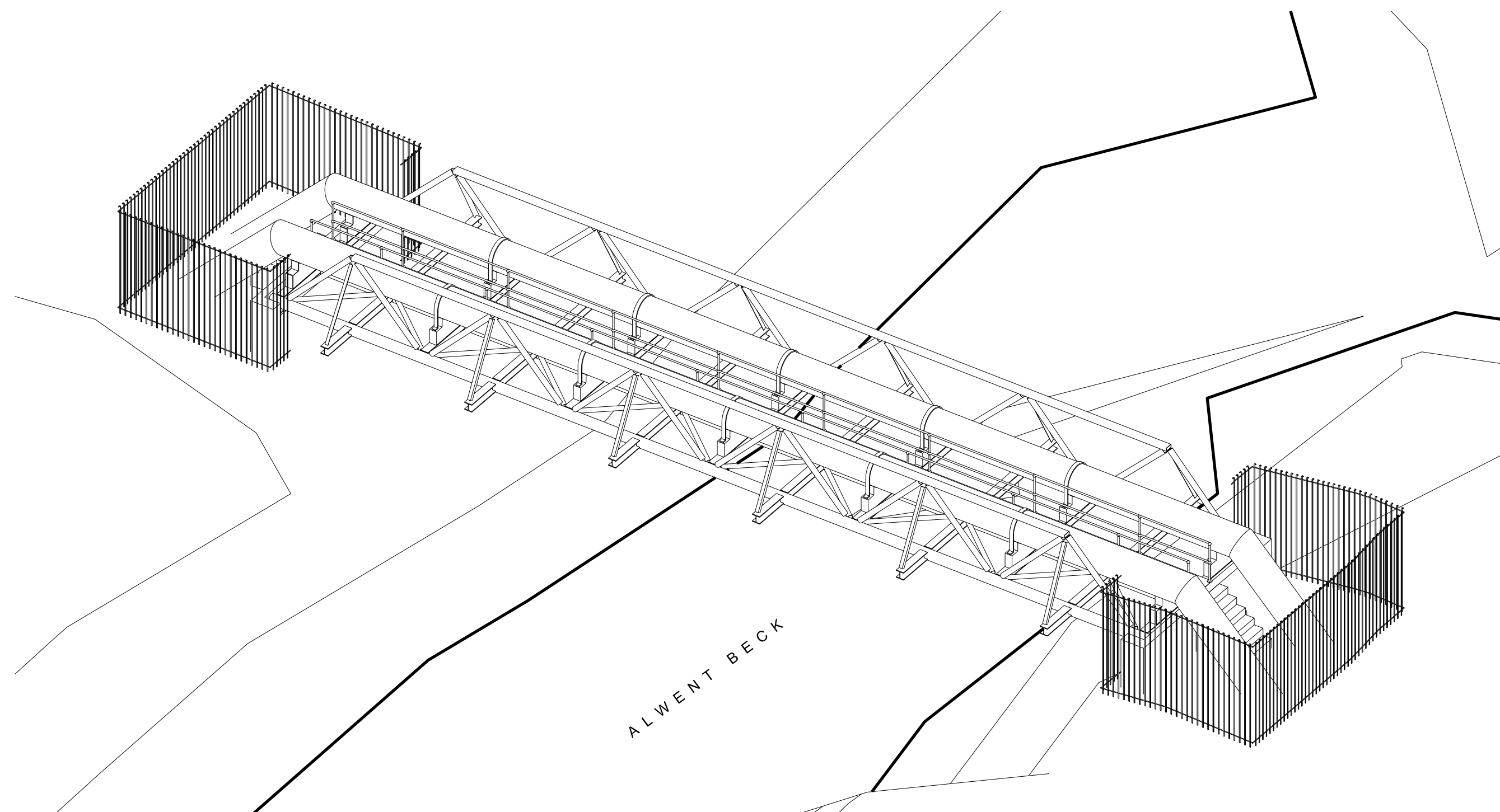

ISOMETRIC VIEW
NOT TO SCALE